

DESIGNER NOTE:
 DIMENSIONS ONLY. STEEL PLATE THICKNESS, WELD AND ANCHOR BOL T SIZES WERE DESIGNED PER INTERNATIONAL BUILDING CODE (IBC) 2006 FOR THE SHAHEED MINAR. ALL STEEL BEAMS AND BRACING MEMBERS COATED WITH 15 MILS IN BOARD THICKNESS FOR CORROSION RESISTANCE. ALL HORIZONTAL PROFESSIONAL ENGINEER LICENSED TO PRACTICE IN THE RESPECTIVE JURISDICTION SHALL BE CONSULTED FOR QUESTIONS CONCERNING OR ADDITIONAL INFORMATION PLEASE CONTACT SAJJAD AHMAD AT sajjad@saahmad.com

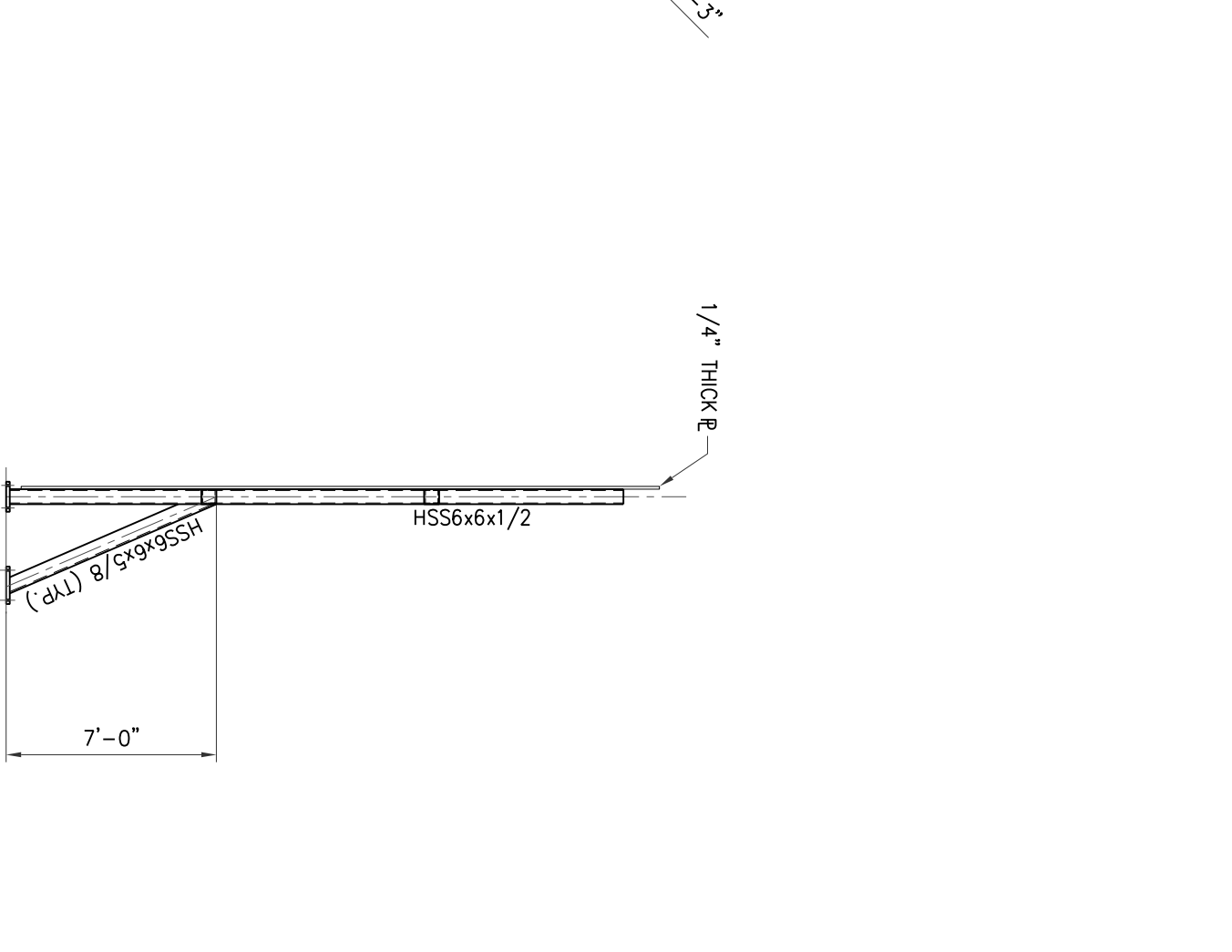
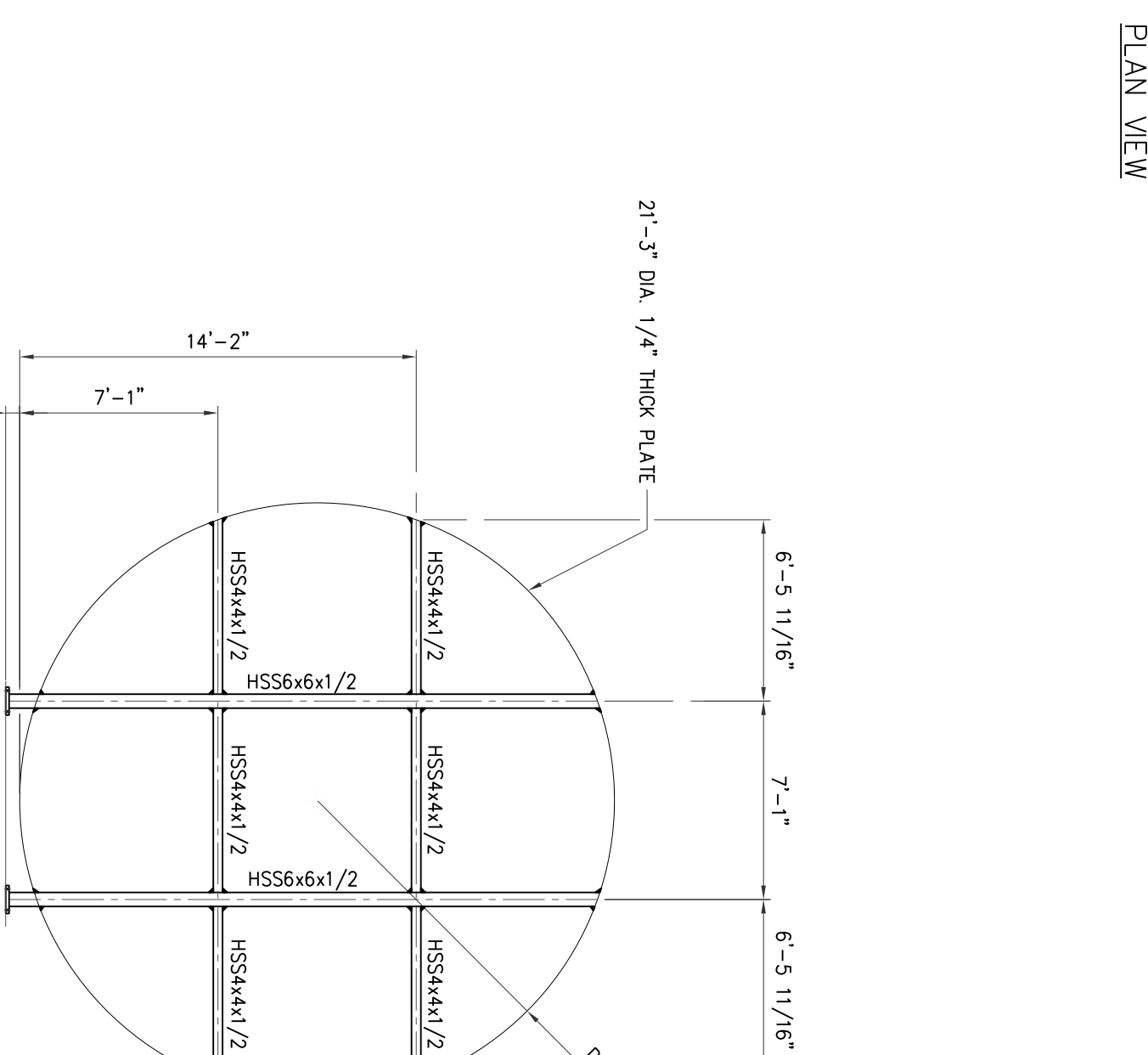
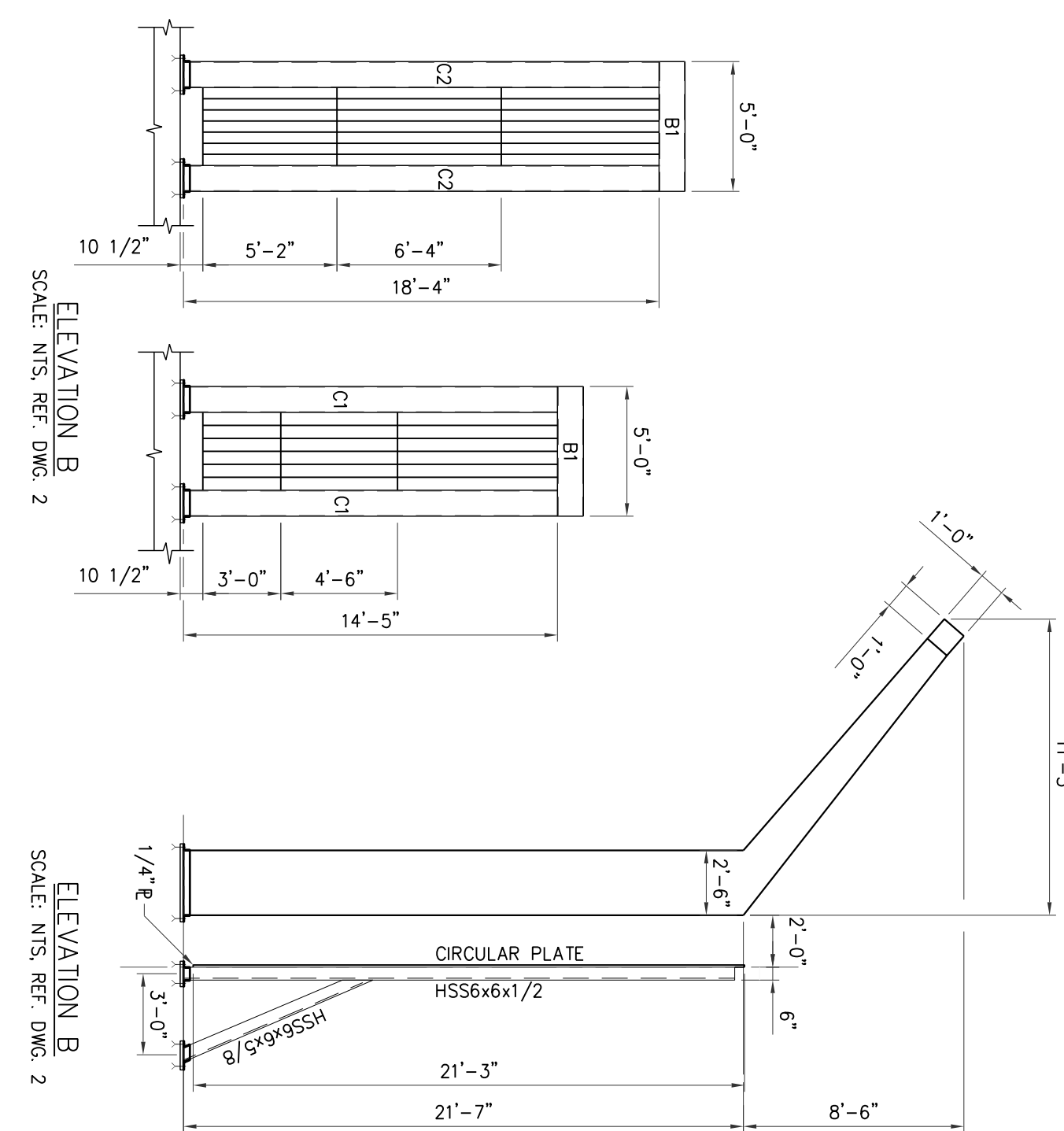
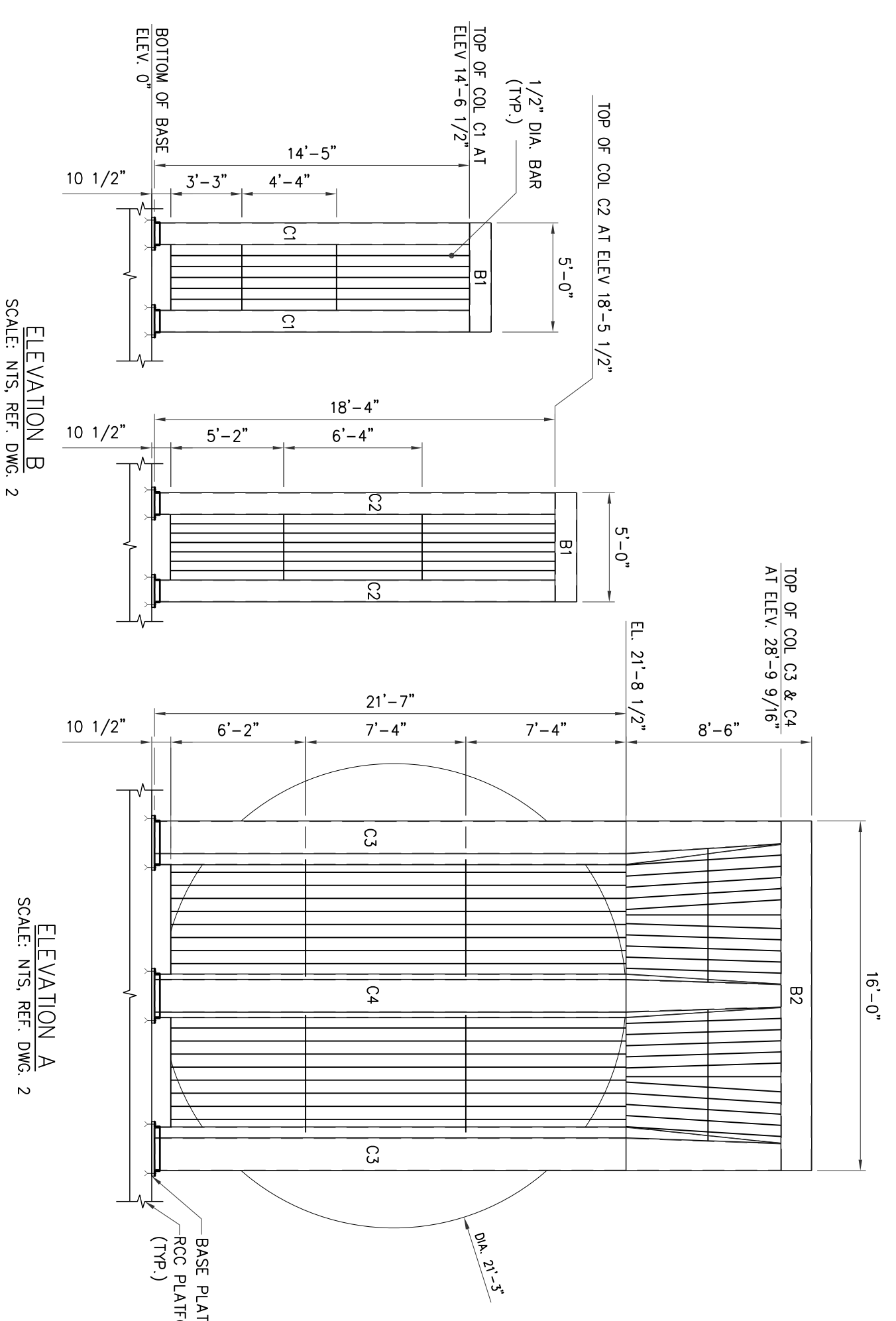

SECTION	BEAM	SECTION	
C1	HSS12x12x5/16 (TRP)	B1	HSS12x12x5/16 (TRP)
C2	HSS12x12x5/16 (TRP)	B2	HSS12x12x5/16 (TRP)
C3	TRAPEZOIDAL COL. W/PL		
C4	TRAPEZOIDAL COL. W/PL		

BACK VIEW OF CIRCULAR
 SCALE: N.T.S. REF. DWG. 2

SIDE VIEW
 SCALE: N.T.S. REF. DWG. 2

NO.	BY	DATE	REVISION
Δ	NH	06/27/10	ISSUED FOR DIMENSIONAL REFERENCE ONLY
∇	NH	05/20/10	REVISED FOR APPROVAL
∇	MSJ	03/09/10	ISSUED FOR APPROVAL

NO.	BY	DATE	REVISION	CHKD.	BY	DATE
Δ	NH	06/27/10	ISSUED FOR DIMENSIONAL REFERENCE ONLY	MTS		06/27/10
∇	NH	05/20/10	REVISED FOR APPROVAL	MTS		05/20/10
∇	MSJ	03/09/10	ISSUED FOR APPROVAL	MH		03/09/10

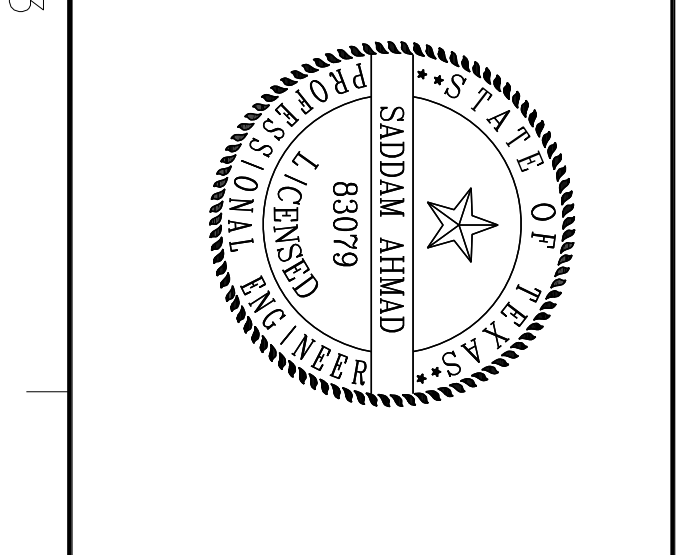

ENGINEERING ALLIANCE INC.
 F-10447

SHAHEED MINAR
 GENERAL ARRANGEMENT DRAWING

DATE: 06/27/10
 PROJECT NO: BAC10003

SCALE: N.T.S.